

Bukit Panjang Govt High School



Secondary One Registration Day 20 December 2018

Sharing on School Matters

Sharing on School Matters

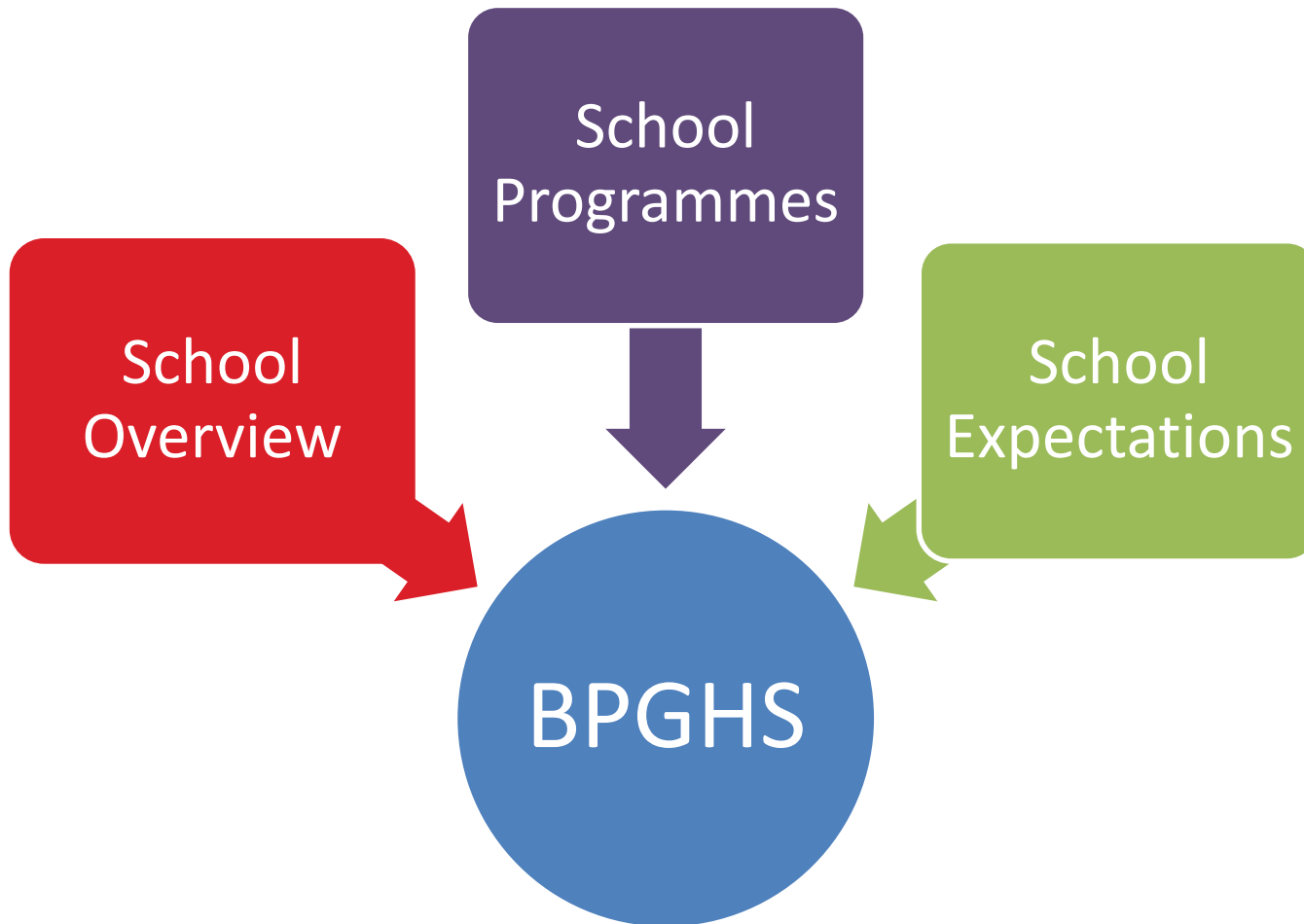

SCHOOL OVERVIEW



Vision – Every BPian a
Passionate Learner, an
Inspiring Leader

Mission – To ignite the joy of
learning through a holistic
education and develop
leaders with a heart to serve

School Values

Responsibility, Resilience, Respect,
Integrity, Care for Others

The BPian Experience



A rigorous core curriculum and an enriching co-curriculum to discover and develop potential



A differentiated curriculum to maximise potential



A nurturing and caring school environment that is responsive to the needs and expectations of BPians

The BPian Experience @ Sec 1

Common Experiences / Signature Events

BP Day, Public Performance, Open House, CCA, Level Dialogues

Niche Programmes

Art Elective Programme, EMAS Programme, Applied Science Programme, West Zone Centre of Excellence (Mathematics)

Confident Person

EL Drama, Leadership Workshop

Active Contributor

Values-in-Action (ViA), Student Initiated Activities (SiA)

Concerned Citizen

Current Affairs Sharing, Heritage Trail, Cyberwellness Programme

Self-Directed Learner

Code for Fun Programme, Geog/Hist Inquiry Field Trip, Maths/Sci Competitions

Art Elective Programme (AEP)

AEP
is a
4-year art
programme
offered from
Secondary 1



At the end of 4 years, students sit for O-level **Higher Art**, a more in-depth study of art than O-Level Art.

EMAS Programme

Elective Programme for Malay Language in Secondary Schools (EMAS)

- Students will take **Higher Malay Language** as a subject participate in a comprehensive EMAS programme from Secondary 1 to Secondary 4.
- Structured 4 year programme aims to nurture the language talents of students so that they can attain a high level of proficiency in the Malay language and a deeper appreciation of Malay culture and literature.
- Highlights include an EMAS Overseas Immersion Programme.

MTL Programmes

Higher MTL

- Students may opt to take up HMTL (i.e Higher Chinese/ Higher Malay/ Higher Tamil) from Secondary 1 (S1) onwards if they have taken MTL or HMTL at the Primary School Leaving Examination (PSLE) and are in the
 - Top 10% of the PSLE cohort; or
 - Top 11%—30% of the PSLE cohort and meet the language criteria i.e. an A* grade in the MTL or at least a Merit in HMTL.

MTL Programmes

Tamil Language

- For students taking TL, lessons will be held at the TL centres after school:
 - TL lessons – Teck Whye Secondary
 - HTL lessons – Jurong West Secondary

Non-Tamil Indian Languages (NTIL)

- For students taking NTIL (e.g. Hindi, Panjabi, Bengali, Urdu), parents are to arrange lessons at the respective NTIL centres during weekends.

** During MTL lessons in BPGHS, students taking TL and NTIL are expected to do their revision during the timeslot.*

Applied Science Programme (ASP)

For all Sec 2 Express, N(A),
N(T) students

Inquiry-driven
develop students'
abilities to question,
research, investigate and
create

Interdisciplinary
cultivate students' perception
of Science as a collective
effort and a way of thinking
rather than just a body of
facts



Phase 1 (Term 1)
Scientific Research
Thinking



Phase 2 (Term 2)
Programming



Phase 3 (Terms 3-4)
Design and Create

Co-Curricular Activities (CCA)

- CCA is compulsory for all students
- Participation has to be continuous throughout the 4 or 5 years in secondary school

Main CCAs				*2 nd CCAs
Uniformed Groups	Sports and Games	Performing Arts	Clubs & Societies	<ul style="list-style-type: none"> • BP Com Link • Health & Sports • Service Learning Club
<ul style="list-style-type: none"> • Girl Guides • NCC (Land) • NPCC • Boy Scouts • ST. John Brigade 	<ul style="list-style-type: none"> • Basketball • Floorball • Fencing • Netball • Volleyball 	<ul style="list-style-type: none"> • Chinese Orchestra • Choir • Dance • Military Band • EL Drama • CL Drama 	<ul style="list-style-type: none"> • Infocomm Club • Science Team • Malay Cultural Society 	

- CCA attainment level will be awarded, and can be converted to bonus points for gaining admission to JCs or Polys.

School with Special Needs Facilities/ Resources

- BPGHS is a mild SEN resource school
- Provision of Allied Educator (Learning & Behavioural Support) [AED(LBS)] to complement the support that classroom teachers presently provide to students with mild Special Educational Needs (Mild SEN)

Subject-Based Banding (SBB)

- SBB provides greater flexibility in subject offering at lower secondary levels, to better cater to the strengths of students in different subjects, and enhance their access to opportunities throughout their educational journey.

Subject-Based Banding (SBB)

- **N(A) and N(T) students** are eligible to take some subjects (English Language, Mathematics, Science and Mother Tongue Languages) at a higher academic level starting from Secondary 1 in 2018 if they have performed well in these subjects at PSLE:
 - N(A) and N(T) students who scored A* or A in a PSLE Standard subject can take the subject at the Express Level; and
 - N(T) students who scored at least C in a PSLE Standard subject or 1 in a PSLE Foundation subject can take it at N(A) Level.
- Cannot offer **more than 3** higher level subjects

Subject-Based Banding (SBB)

- **2nd Intake (Mid-Year Inserts)**

- If meets school-based criteria, option to offer subject from Semester 2

Course	School-based Results
N(A)	75% or higher in specific subject & 60% or higher in the overall average
N(T)	75% or higher in specific subject & 60% or higher in the overall average

- **3rd intake (End-Year Inserts)**

- If meets school-based criteria, option to offer subject in Sec 2

School Reporting & Dismissal

- All students must be punctual for school, lessons, CCA and other committed school activities.
- Students must be at the respective venues for assembly by 7.25 am. Students will be deemed as late if they are not at the venues when flag-raising ceremony commences at 7.30 am.

School Reporting & Dismissal

- A typical day in BPGHS

Time	Activities
By 7.25 am	Report to School
7.30 am	Flag Raising Ceremony
7.50 am	Start of Lessons (1 hour slot per period)
9.50 am – 10.30 am	Lower Secondary Recess Time (40 min) <ul style="list-style-type: none"> • 7 Food Stalls (inclusive 1 vegetarian, 3 halal) • 1 Drinks Stall • 1 Café
	<div style="background-color: #800000; color: white; padding: 5px; text-align: center;"> Price of Food ranges from \$2 - \$2.50 </div>
12.30 pm – 12.40 pm	Snack Break (10 min)
12.40 pm OR 1.40 pm OR 2.40 pm	School Dismissal Hours <i>* NT students taking SBB subjects may have school days</i>
2.40 pm (or earlier) – 3.10 pm	Lunch Break (30 min)
3.10 pm – 4.00 pm	Consultations/ Remediation Programmes
4.00 pm – 6.00 pm	CCA Programme (ranges from 1 – 2 sessions per week)

School Assessment Practices

Mid-Year Examinations (MYEs) were removed for S1 to S3 to

1. devote more time and space to make teaching and learning more engaging
 - š Greater focus on mastery; developing depth, extending learning, strengthening conceptual understanding
 - š Develop 21C competencies
 - š Opportunities for checks for understanding, feedback, student involvement
2. reduce the stress associated with high stakes testing

Secondary 1 - 3 (Express, Normal Academic and Normal Technical)

Continual Assessment (CA 1 & 2)	Semestral Assessment (SA2)	Total
40%	60%	100%

* Students will not be eligible for school-based and MOE academic awards if they are absent for any of the components in SA2.

Secondary 1 & 2 Subjects with no Semestral Assessment (Food & Consumer Education, Design & Technology, Art, Geography and History)

Semester	Continual Assessment (CA)	Total
1 & 2	100%	100%

Academic Grading Systems

Sec 1 to 4 Express / Sec 5 Normal

Grades	(%)	Description
A1	75 & Above	Demonstrates very good understanding of the subject.
A2	70-74	
B3	65-69	Demonstrates good understanding of the subject.
B4	60-64	
C5	55-59	Demonstrates adequate understanding of the subject.
C6	50-54	
D7	45-49	Demonstrates elementary understanding of the subject.
E8	40-44	
F9	39 & Below	

Sec 1 to 4 Normal (Academic)

Grades	(%)	Description
1	75 & Above	Demonstrates very good understanding of the subject.
2	70-74	
3	65-69	Demonstrates good understanding of the subject.
4	60-64	
5	50-59	Demonstrates adequate understanding of the subject.
U	49 & Below	

Sec 1 to 4 Normal (Technical)

Grades	(%)	Description
A	75 & Above	Demonstrates very good understanding of the subject.
B	70-74	
C	60-69	Demonstrates good understanding of the subject.
D	50-59	
U	49 & Below	Demonstrates adequate understanding of the subject.
		Has not met the minimum requirements for the subject.

Promotion Criteria

Express Course – Criteria For Movement

	Met Minimum Attainment Level: Pass in both EL and combined percentage of all subjects	Not Met Minimum Attainment Level
Sec 1E	Promoted to Sec 2E	Laterally Transferred to Sec 2N(A)
Sec 2E	Promoted to Sec 3E	Laterally Transferred to Sec 3N(A)

Promotion Criteria

Normal (Academic) Course – Criteria For Movement

	Met Minimum Attainment Level: Grade 5 or better in - EL and 2 other subjects OR - 4 subjects	Met Minimum Attainment Level AND Lateral Transfer Requirement: Minimum 70% for the combined percentage of all subjects and found suitable e.g. at least 70% for EL, Maths and Science; positive feedback from form teachers	Has Not Met Minimum Attainment Level	
			At or above maximum age	Below maximum age
Sec 1N(A)	Promoted to Sec 2N(A)	Laterally Transferred to Sec 2E	Advanced to Sec 2N(A)	Retained at Sec 1N(A)
			[May be transferred to Sec 2N(T) if deemed more suited for N(T) course]	
Sec 2N(A)	Promoted to Sec 3N(A)	Laterally Transferred to Sec 3E	Advanced to Sec 3N(A)	Retained at Sec 2N(A)

Promotion Criteria

Normal (Technical) Course – Criteria For Movement

	Met Minimum Attainment Level: Grade D or better in 2 subjects, one of which should be English Language or Mathematics	Met Minimum Attainment Level AND Lateral Transfer Requirement: Minimum 70% for the combined percentage of all subjects and found suitable e.g. at least 70% for EL, Maths and Science; positive feedback from form teachers	Has Not Met Minimum Attainment Level	
			At or above maximum age	Below maximum age [May be advanced to next level within N(T) course]
Sec 1N(T)	Promoted to Sec 2N(T)	Laterally Transferred to Sec 2N(A) in the following year	Advanced to Sec 2N(T)	Retained at Sec 1N(T)
Sec 2N(T)	Promoted to Sec 3N(T)	Laterally Transferred to Sec 2N(A) in the following year	Advanced to Sec 3N(T)	Retained at Sec 2N(T)
Sec 3N(T)	Promoted to Sec 4N(T)	Laterally Transferred to Sec 3N(A) in the following year	Advanced to Sec 4N(T)	Retained at Sec 3N(T)

School Rules & Regulations

- Attendance
 - Attendance in school is compulsory
 - Parent/Guardian must call the school to notify the General Office of his/her child/ward's absence by 7.30 am or before the morning assembly.
 - Absence from school must be supported by a medical certificate or a letter of excuse (up to a maximum of three letters per semester) from the parent/guardian.

School Rules & Regulations

- Use of Personal Electronic Devices (e.g. handphones)
 - Students are not encouraged to bring their PEDs to school. Those who do so can only use their PEDs during recess and after curriculum time.
 - PEDs will be kept safely by the teacher if any of the following are not observed and result in possible disruptions to lessons, and returned by the end of the day.
 - Disciplinary action will be taken against any student found misusing technology (e.g. use of social media to invade privacy of staff or students and/or leading to cyber bullying)

Conduct Grade

- A conduct grade reflects a student's general conduct or behaviour throughout the semester.
- Only students with conduct grade 'Good' and above will be eligible for any government or school awards, e.g. Edusave/Eagles/Colours/Edusave Character Award.

Conduct Grade	Descriptors
Excellent	<p>A student who consistently behaves in an exemplary manner. He/she</p> <ul style="list-style-type: none">• is always courteous and respectful towards others and• always does things well on his/her own and• shows a very clear sense of right and wrong through speech and action and• is always dependable; always completes task on time and• contributes actively to the betterment of others.

Discipline Management for Major and Minor Offences

Offences	Description	Consequences
<p>Major</p>	<ul style="list-style-type: none"> • Arson • Theft/Shoplifting in or outside school/Misappropriation of property • Vandalism • Assault/Fighting • Gambling (includes possession of gambling cards) • Gangsterism/Involvement in secret society activities/Extortion/Rioting/Unlawful assembly • Pornography (consumption/possession/distribution/sale of) • Possession of weapons • Sexual misconduct • Smoking/Possession of tobacco products • Alcohol/Drug/Inhalant abuse (possession/consumption) • Other criminal offences • Bullying (cyber, verbal, physical) • Forgery • Open defiance and/or rudeness • Leaving school grounds without permission • Truancy/Unexcused Absences 	<ul style="list-style-type: none"> • Conduct grade down by at least 2 grades • Caning • Suspension (In school/At home) • Compensation (where relevant) • Home involvement • Counselling/Referral to external agencies • Service to school • Police assistance (if needed) <p>Others: Not eligible to apply for overseas trips</p> <ul style="list-style-type: none"> - Step down from leadership position in CCA/Class/Student Council - Suspension from school/co-curricular activities (includes any of the following): <ul style="list-style-type: none"> ○ CCA/non-CCA related matches/competitions ○ SYF/performance ○ no promotion in uniformed groups

Caning

- Caning will be meted out, in accordance with MOE guidelines and the school rules, as one of the possible consequences for major offences.
- Caning, with a range of 1 to 3 strokes of a light cane, may be given on the palms, or buttocks over clothing, and nowhere else (for male offenders only).
- Caning will be carried out by either the Principal or a delegated senior member of staff, in the General Office.
- The student's parents will be informed either before or immediately after the caning has been meted out with details of the offence and the follow-up actions that the school will be taking.
- The school will take appropriate follow-up actions to counsel the student concerned.

Discipline Management for Major and Minor Offences

Major

- Cheating in assessments/tests/examinations
- Breach of assessments/tests/examinations procedures

- Home involvement
- Counselling/Referral to external agencies
- Detention/Service to school (each day of truancy or unexcused absence)
- Others:
 - Not eligible to apply for overseas trips
 - Step down from leadership position in CCA/Class/Student Council
 - Suspension from school/co-curricular activities (includes any of the following):
 - o CCA/non-CCA related matches/competitions
 - o SYF/performance
 - o no promotion in uniformed groups
- Home involvement
- Counselling/Referral to external agencies
- Results nullified
- Others:
 - Not eligible to apply for overseas trips
 - Step down from leadership position in CCA/Class/Student Council
 - Suspension from school/co-curricular activities (includes any of the following):
 - o CCA/non-CCA related matches/competitions
 - o SYF/performance
 - o no promotion in uniformed groups

*Conduct grade down by at least 2 grades for repeated offenders.

Discipline Management for Major and Minor Offences

<p>Minor</p>	<ul style="list-style-type: none"> • Late-coming • Skipping lessons/remedial/supplementary/enrichment programmes/assembly/detention/service to school without valid reasons • Improper attire and grooming • Littering • Not doing assignments • Using vulgar language • Consuming food/drink outside cafe/canteen • Disruptive/inappropriate behaviour 	<p><u>Committed offence 1 – 3 times</u></p> <ul style="list-style-type: none"> • Verbal warning • Home involvement <p><u>Committed offence 4 - 7 times</u></p> <ul style="list-style-type: none"> • Conduct grade down by 1 grade • Home involvement • Counselling/Referral to external agencies • Detention/Service to school on the 4th count-
<p>Minor</p>		<p><u>Committed offence more than 7 times</u></p> <ul style="list-style-type: none"> • Conduct grade down by 2 grades • Home involvement • Counselling/Referral to external agencies • Detention/Service to school on every count • Others: <ul style="list-style-type: none"> - Not eligible to apply for overseas trips - Step down from leadership position in CCA/Class - Suspension from school/co-curricular activities (includes any of the following): <ul style="list-style-type: none"> ○ CCA/non-CCA related matches/competitions ○ SYF/performance ○ no promotion in uniformed groups

Research shows that parent partnership with school in children's learning is positively related to achievement (academic, character and holistic development)

Look forward to the strong home-school partnership BPGHS and parents forge ahead!



Venues for Sale of Textbooks & Uniforms

LEVEL 1

BLK H

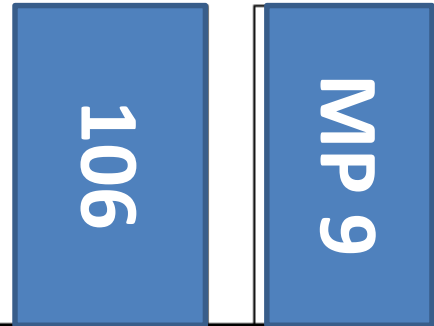

BLK F

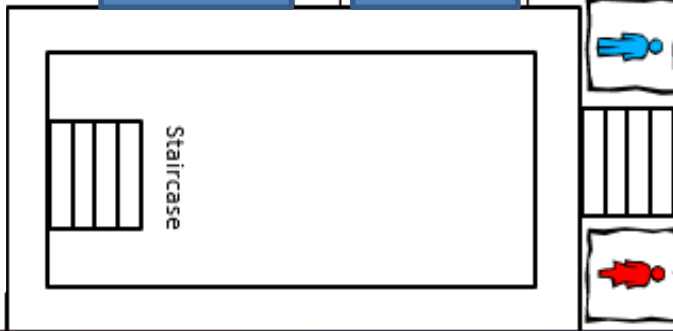

Staircase

BLK J

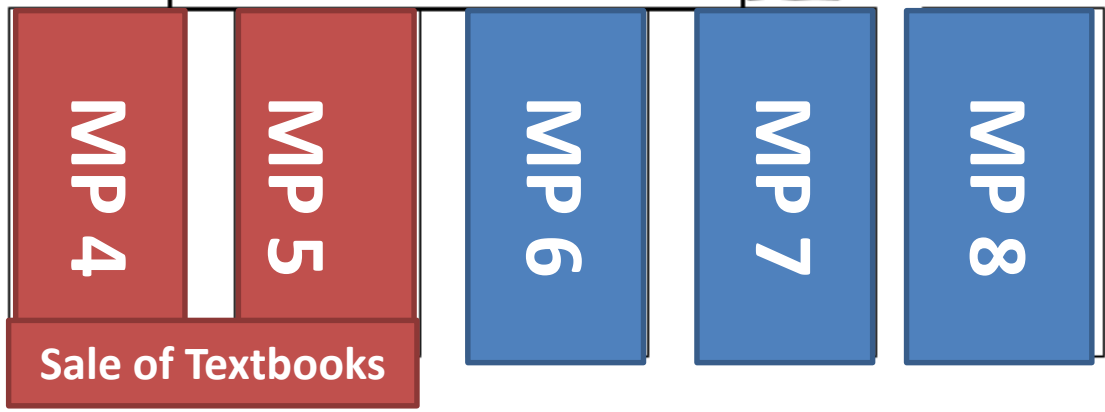

BLK A

